

E-1. Removal of used ISE Fluid Pack

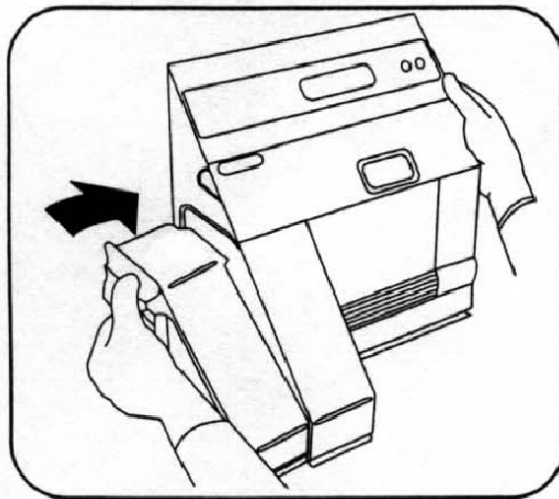

E-2. Installing ISE Fluid Pack

Changing the ISE Pack and Resetting the Fluid Level (VetLyte and AVL 9100)

The VetLyte monitors the level of solutions in the ISE Fluid Pack and displays the amount remaining. At 5% fluid remaining, the unit will display the message **Fluid Pack Low** at **Analyze Sample?** and **Standby!** prompts. This message will go away only after the fluid counter has been reset to 100%.

To check the status of fluid remaining in the pack:

1. Press NO until the prompt, **Operator Functions?** is displayed. Press YES.
2. The prompt **Check/Change Reagent Pack?** will be displayed.
3. Press YES. The analyzer will display the amount of fluid remaining then the prompt **New Reagent Pack Installed?** will appear.

Note: If ample fluid remains in the pack and it is not necessary to change it, press NO to return to **Analyze Sample?**

4. To change the pack, just grasp the extended portion of the pack and slide it out. If removal is difficult, press on the end of the fluid pack guide pin (protruding through the connector located to the left of the measuring chamber inside the front door). See illustration E-1.
5. Prepare the new ISE Fluid Pack by carefully removing the red protective strip.

Note: Once the protective strip is removed, be sure to keep the pack upright to avoid spillage. Save the protective strip to use to close the ports on the pack prior to disposal.

6. Slide the new pack into position on the left side of the analyzer. See illustration E-2.
7. Press YES to indicate that a new fluid pack is installed. The analyzer will prompt **Are You Sure?**
8. Press YES, and the VetLyte Electrolyte Analyzer will automatically reset the fluid pack counter to 100% and commence system calibration.